



Torque Motor Drive Quick Disconnect Spider Universal Spacer Couplings



Coupling Star Spider Technical Specification JOY LOVE EQVT HIC Manufactured Brand

Universal Star Couplings ensures quick and easy installation in reciprocating pumps, generator sets, diesel and gas engines and other such drives, in a way, coupling installation requires no special tools due to simple construction, every other spider arm is an idler and can be advanced to the load carrier jaws & thus functioning as a spare spider in every coupling.



'L' Type Coupling



'SW' Type Coupling



'RRS' Type Coupling

Power Transmission hic Spider Spacer Couplings

1. **L Type** pumps drive lovejoy interchangeable **jaw spider** couplings 050 to 280 sizes upto 192 mm OD 75 mm maximum bore.
2. **SW Type** centrifugal pumps run rathi interchangeable **snap wrap** couplings 095 to 225 sizes upto 323 mm OD 80 mm max bore. Ease of use as no need to dismantle connected equipment while replacing element thus **saving machinery downtime**.
3. **RRS Type** engines hi-speed rotation rathi interchangeable **spacer** couplings 095 to 226 sizes 90-100-140mm spacer length 70 mm max bore.
4. **RRL Type** engines hi-speed rotation rathi interchangeable spacer couplings 095 to 225 sizes 90-100-140mm **spacer** length 70 mm max bore.
5. **C-series** Higher Torque lovejoy interchangeable flex shaft cushion couplings 226 to 2955 sizes upto 80mm max bore.

Two standard hubs, one cushion set and collar with hardware makes good choice.

Select wisely by determining (i) service factor (ii) design power running motor hp x service factor (iii) choose proper coupling from technical data table (iv) verify bore size of chosen coupling , whether can be used.



Contact For Quote:

HIC INTERNATIONAL CO. (Cast Iron Products Coupling Spider Div.)

D-136, Shankar Road, New Delhi - 110060, India

Phone: 91-11-6547 2400, 2874 5120

Fax: 91-11-2874 2791

E-mail : universal@hic-india.com; belts@universaldelhi.org

Website : <http://www.rubber-steel-industrial-products.com>

Key personnel : Mr. Anil Gupta, President



**Torque Motor Drive
Quick Disconnect
Spider Universal
Spacer Couplings**

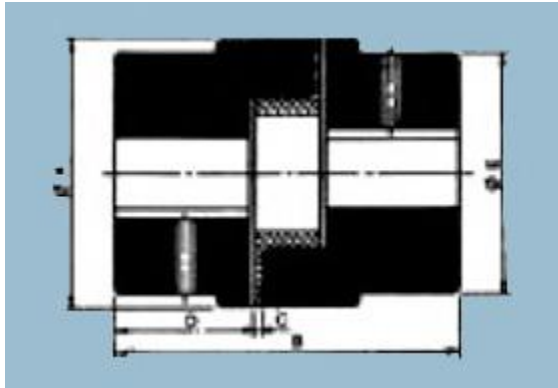

Coupling STAR Spider Spacer Product Specification

Coupling size	material Al=aluminium CI=Castiron	Bore		coupling outside diameter A	coupling overall length B	gap between jaw & body C	coupling length thru bore D	coupling hug diameter E	torque kg.M.	Power per100 rev/min KW	Power per100 rev/min HP
		Pilot	Max								
050-SL	CI	5	16	27	42	1	15	27	0.29	0.03	0.04
070-SL	CI	9	20	36	51	2	19	36	0.50	0.04	0.06
070-SL	AL	9	20	36	51	2	19	36	0.40	0.037	0.05
075-SL	AL	14	22	44.5	55	2	21	39	0.80	0.80	0.11
075-SL	CI	9	22	44.5	55	2	21	39	1.00	0.10	0.13
095-SL	AL	15	28	54	63	2	25	49	1.70	0.17	0.23
095-SL	CI	15	28	54	63	2	25	49	2.15	0.22	0.30
099-SL	AL	15	30	65	72	2	27	51	2.80	0.29	0.39
099-SL	CI	15	30	65	72	2	27	51	3.58	0.37	0.50
100-SL	AL	15	38	65	88	2	35	57	4.00	0.41	0.55
100-SL	CI	15	38	65	88	2	35	57	4.73	0.49	0.66
110-SL	CI	15	42	85	108	3	43	76	8.95	0.93	1.25
150-SL	CI	15	48	96	115	3	45	80	14.32	1.49	2.00
190-SL	CI	36	55	115	133	3	54	102	19.34	2.01	2.70
225-SL	CI	36	60	127	153	3	64	108	27.00	2.81	3.77
226-SL	CI	36	65	137	178	3	70	115	32.33	3.36	4.51
276-SL	CI	45	75	157	200	3	80	127	53.71	5.59	7.50
280-SL	CI	45	75	192	200	3	80	140	76.69	8.30	11.12
295-SL	CI	58	90	237	238	3	95	160	130.41	13.58	18.21
295-SL	CI	73	100	237	264	3	108	180	217.35	22.64	30.35



Contact For Quote:

HIC INTERNATIONAL CO. (Cast Iron Products Coupling Spider Div.)

D-136, Shankar Road, New Delhi - 110060, India

Phone: 91-11-6547 2400, 2874 5120

Fax: 91-11-2874 2791

E-mail : universal@hic-india.com; belts@universaldelhi.org

Website : <http://www.rubber-steel-industrial-products.com>

Key personnel : Mr. Anil Gupta, President



- * Coupling equivalent & interchangeable to Love Joy Type 'L' & Fenner brand Essex Standard.
- * Coupling Spacer type of length 75/90/100/135/140/180 mm equivalent & interchangeable to Rathi coupling 'RRL' & 'RRS' also manufactured & supplied.
- * Coupling External Spider, 'SW' eqvt & Coupling Cushion Type, 'C' eqvt. also manufactured.
- * Bore other than specified available on order.
- * Coupling Star also manufactured with Quick-Fit Taper Lock bush system.

Star Coupling Information To Be Supplied With Enquiry or Order

- Coupling size no. i.e., SL 070 or SL 099 & so on.
- Material grade i.e. Aluminum or Cast Iron & so on.
- Outer Diameter, O.D. in mm.
- Specific bore size in mm.
- Star coupling regular type or with quick-fit taper lock bush system required .
- Application detail.
- Quantity in nos.

Disclaimer: Information's, written and verbal are provided by HIC, relative to its products which it determines to be reliable & no liabilities of whatsoever nature in regards to its uses. The purchaser of UNIVERSAL brand industrial products should determine for itself the suitability of such products.



Contact For Quote:
HIC INTERNATIONAL CO. (Cast Iron Products Coupling Spider Div.)
D-136, Shankar Road, New Delhi - 110060, India
Phone: 91-11-6547 2400, 2874 5120
Fax: 91-11-2874 2791
E-mail : universal@hic-india.com; belts@universaldelhi.org
Website : <http://www.rubber-steel-industrial-products.com>
Key personnel : Mr. Anil Gupta, President



Motor-Generator Drive Flexible Tyre Couplings Technical Specifications



Rubber Coupling Technical Specification TYRE HIC Manufactured UNIVERAL Brand

Universal Tyre Couplings ensures **high torque transmitting capacity** in motor generators, etc in various industrial machines, in a way, the true **tyre material** is made from neoprene/ natural/synthetic rubber compounds reinforced with Rayon/ Nylon/ Polyester Cord to give superior rating & long durability, **bore size** is well matched to attain maximum speed (rpm) ensuring minimum to **nil slippage** of the **flexible** element out from the coupling assembly in case of any faulty installation.



Tyre Coupling

Rubber Coupling FLEXIBLE SHAFT Drive Product Specification

- TC-series Conventional rubber tyre unique interchangeable motor couplings 006 to 024 sizes upto 530 mm Outer Diameter 170 mm maximum bore and spare tyre.
- F series Multidirectional flexible rathi interchangeable tyre couplings 40 to 200 sizes upto 190 mm max bore and spare tyre.
- PH series New Generation flexible fenaflex interchangeable shaft couplings 96 to 450 sizes upto 175 mm max bore and spare tyre. Ease of use as no lubrication needed, absorbs big misalignment thus saves downtime.
- HRC-series fenner interchangeable flexible shaft cushi on couplings 090 to 280 sizes upto 115mm max bore and spare element.

Bore sizes : 6mm to 280mm
Speed (rev./min.) : From 500 to 7000 rpm.



Contact For Quote:

HIC INTERNATIONAL CO -Motors Drive Tyre Coupling Div

D-136, Shankar Road, New Delhi - 110060, India

Phone: 91-11-6547 2400, 2874 5120

Fax: 91-11-2874 2791

E-mail : universal@hic-india.com; belts@universaldelhi.org

Website : <http://www.rubber-steel-industrial-products.com>

Key personnel : Mr. Anil Gupta, President



Motor-Generator Drive Flexible Tyre Couplings Technical Specifications



Motor Coupling Dimension Details TC - series

Coupling tyre size	Tyre coupling max. bore mm	Max speed RPM	Count rating	Couplings approx. dimension (mm)				
			HP/100 RPM	Coupling tyre O.D. (A)	Coupling length (L)	Hub dia (D)	Flange length (E)	Gap bet. two flanges (M)
001-TC/Z	9	6000	Nominal	42	54	27	19	16
002-TC/Z	11	6000	Nominal	54	68	38	24	20
003-TC/Z	14	6000	Nominal	70	78	43	27	24
004-TC/Z	18	5500	Nominal	93	74	30	26	22
005-TC/Y	20	6500	0.07	97	74	35	25	24
006-TC/X	22	5500	0.14	105	84	38	32	20
007-TC/W	24	5500	0.21	105	111	43	40	31
008-TC/V	28	5500	0.28	120	95	51	37	21
009-TC/U	32	5500	0.42	135	108	58	39	30
009-TC/US	38	5500	0.55	144	120	66	48	24
010-TC/T	44	4400	0.63	160	132	71	49	34
011-TC/S	45	4300	0.77	164	133	75	51	31
012-TC/R	44	4200	0.98	176	147	71	53	41
013-TC/Q	50	3750	1.54	188	145	80	53	39
014-TC/P	55	3200	2.1	212	155	95	56	43
015-TC/O	70	2750	3.1	240	173	118	62	49
016-TC/N	85	2700	4.2	270	181	140	80	45
017-TC/M	90	2600	6.6	280	215	145	76	63
018-TC/L	95	2550	8.4	310	195	154	90	15
019-TC/K	100	2450	11.0	316	202	159	95	10
020-TC/J	125	2200	16.8	370	225	203	110	6
021-TC/I	125	2000	21.0	370	240	203	115	10
022-TC/H	140	1700	33.6	412	256	237	118	20
023-TC/G	140	1600	52.0	448	280	230	125	30
024-TC/F	170	1300	75.2	530	282	315	128	26
025-TC/E	145	1250	98.1	546	365	260	147	71
026-TC/D	145	1080	117.1	630	457	387	203	51
027-TC/C	on enq	960	138	746				On enquiry
028-TC/B	on enq	960	173	746				On enquiry

Contact For Quote:

HIC INTERNATIONAL CO -Motors Drive Tyre Coupling Div

D-136, Shankar Road, New Delhi - 110060, India

Phone: 91-11-6547 2400, 2874 5120

Fax: 91-11-2874 2791

E-mail : universal@hic-india.com; belts@universaldelhi.org

Website : <http://www.rubber-steel-industrial-products.com>

Key personnel : Mr. Anil Gupta, President



Motor-Generator Drive Flexible Tyre Couplings Technical Specifications



Coupling Sectional View (TC-SERIES)

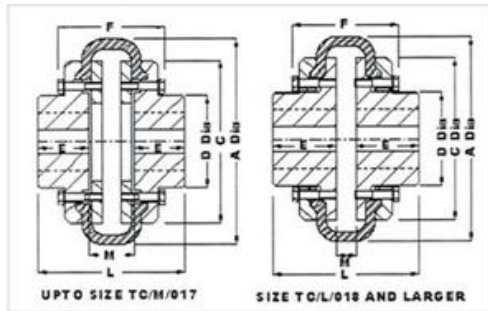

TC Rubber Tyre Couplings

Flexible Coupling Dimension Details F - series

Coupling flexible tyre size	Tyre coupling bore		A mm	L mm	D mm	E mm	C mm	G** mm	M** mm	F mm	Motor power per 100 rev./min kw.	Power per 100 rev./min H.P.	Max speed rev/min
	min mm	max. mm											
40-F	13	30	104	66	-	22	82	43	22	-	0.20	0.26	4400
45-F	13	32	120	74	-	25	94	43	24	-	0.35	0.46	4400
50-F	18	38	133	89	79	32	100	43	25	-	0.50	0.67	4400
60-F	18	48	165	109	73	38	125	43	33	-	1.05	1.40	3900
70-F	20	55	197	130	82	45	144	10	40	101	1.60	2.14	3600
80-F	26	65	211	145	95	51	167	10	43	106	2.55	3.41	3000
85-F	32	70	222	150	103	53	179	13	44	107	3.10	4.15	2900
90-F	32	76	235	160	110	57	188	13	46	119	3.75	5.02	2800
100-F	32	85	254	168	124	60	216	13	48	123	5.19	6.95	2500
110-F	32	90	279	174	134	65	233	14	44	127	7.32	9.80	2200
120-F	39	102	314	201	152	76	264	14	49	140	12.20	16.34	2000
140-F	76	120	359	211	195	89	311	14	24	152	19.20	25.72	1700
160-F	75	140	402	234	216	102	345	19	30	156	32.10	43.01	1500
180-F	75	175	470	274	266	114	398	19	46	188	57.00	76.38	1400



Contact For Quote:

HIC INTERNATIONAL CO -Motors Drive Tyre Coupling Div

D-136, Shankar Road, New Delhi - 110060, India

Phone: 91-11-6547 2400, 2874 5120

Fax: 91-11-2874 2791

E-mail : universal@hic-india.com; belts@universaldelhi.org

Website : <http://www.rubber-steel-industrial-products.com>

Key personnel : Mr. Anil Gupta, President



Motor-Generator Drive Flexible Tyre Couplings Technical Specifications



G* is the amount by which clamping screws need to be withdrawn to release tyre.

M** is the distance between flanges.

Normally shaft ends may be kept M distance apart, however, they can be kept at larger distance apart. Care being taken that sufficient shaft keyway length is covered by the Hub. The shaft length can also be brought nearer each other keeping in mind the end-play between the shafts to avoid chattering.

Coupling Sectional View (F-SERIES)

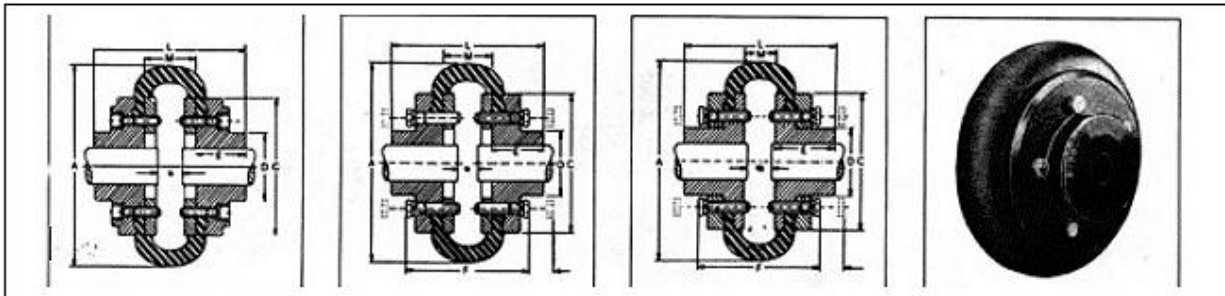

From Size 40 F to 60 F

From Size 70 F to 120 F

From Size 140 F & onwards

F Tyre Couplings



Contact For Quote:

HIC INTERNATIONAL CO -Motors Drive Tyre Coupling Div

D-136, Shankar Road, New Delhi - 110060, India

Phone: 91-11-6547 2400, 2874 5120

Fax: 91-11-2874 2791

E-mail : universal@hic-india.com; belts@universaldelhi.org

Website : <http://www.rubber-steel-industrial-products.com>

Key personnel : Mr. Anil Gupta, President



Motor-Generator Drive Flexible Tyre Couplings Technical Specifications



Flexible Shaft Coupling Dimension Details

Flex shaft coupling size	Coupling max. bore mm (6)	Max speed RPM	Rating		Couplings approx. dimension (mm)				
			Torque motor Kg. M.	H.P./100 RPM	Tyre O.D. (1)	Coupling length (2)	Hub dia (3)	Flange length (4)	Gap bet. two flanges (5)
34-PH	10	7000	Nominal	Nominal	34	34	14	16	6
40-PH	12	7000	-do-	-do-	40	40	17	19	8
46-PH	15	6500	0.87	0.12	46	40	22	19	8
56-PH	18	6000	1.08	0.15	56	48	26	22	11
66-PH	25	6000	1.52	2.21	66	54	36	25	11
76-PH	27	6000	1.81	0.25	76	66	39	30	14
86-PH	34	6000	2.90	0.40	86	76	49	35	14
96-PH	36	5500	3.62	0.50	96	76	51	35	16
106-PH	38	5500	4.35	0.60	106	76	54	35	18
116-PH	42	5500	5.43	0.75	116	88	60	40	22
126-PH	48	5500	9.00	1.25	126	88	68	40	22
140-PH	50	5500	12.70	1.75	140	100	72	46	26
160-PH	57	5000	16.40	2.25	160	108	82	50	28
178-PH	60	4500	22.0	3.00	178	128	100	60	32
190-PH	65	4000	29.0	4.00	190	146	105	70	30
218-PH	75	3500	43.5	6.00	218	160	124	75	36
250-PH	80	3000	62.0	8.50	250	192	145	90	40
272-PH	100	2750	80.0	11.00	272	205	163	90	55
292-PH	105	2600	109	15.00	292	228	168	105	47
316L-PH	90	2500	174	24.00	316	195	150	90	47
316H-PH	115	2500	174	24.00	316	245	190	115	47
342L-PH	90	2250	232	32.00	342	195	150	90	53
342H-PH	120	2250	232	32.00	342	255	198	120	53
390L-PH	100	2000	290	40.00	390	218	165	100	57
390H-PH	140	2000	290	40.00	390	298	230	140	57
450L-PH	130	1600	508	70.00	450	270	216	125	60
50H-PH	175	1600	508	70.00	450	360	286	170	60
520L-PH	150	1400	726	100	520	294	250	135	62
520H-PH	220	1400	7176	100	520	384	354	180	62
600-PH		1300	1310	180	600				
672-PH		1100	1960	270	672				
725-PH		950	2900	400	725				
812-PH		850	4356	600	812				
1000-PH		750	6534	900	1000				
1100-PH		650	8712	1200	1100				
1175-PH		550	10890	1500	1175				
1250-PH		500	14520	2000	1250				



Contact For Quote:

HIC INTERNATIONAL CO -Motors Drive Tyre Coupling Div

D-136, Shankar Road, New Delhi - 110060, India

Phone: 91-11-6547 2400, 2874 5120

Fax: 91-11-2874 2791

E-mail : universal@hic-india.com; belts@universaldelhi.org

Website : <http://www.rubber-steel-industrial-products.com>

Key personnel : Mr. Anil Gupta, President



Motor-Generator Drive Flexible Tyre Couplings Technical Specifications



Coupling Sectional View (PH-SERIES)

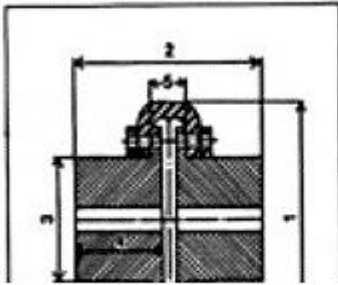

Up to Size 520 PH

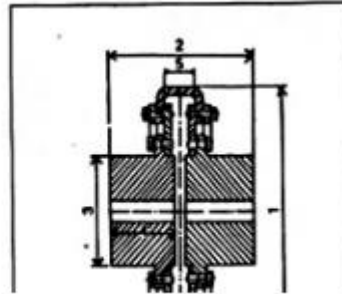

For Sizes 600 PH to 1250 PH

PH Tyre Coupling

Coupling Tire Information To Be Supplied With Enquiry or Order

1. Motor HP rating i.e. 15 or 60 Horse Power & so on.
2. RPM at which coupling is to run i.e. 650 or 1400 & so on.
3. Bore size in mm i.e. 9 or 15 mm & so on.
4. Coupling Type i.e. TC series or F series or PH series.
5. Machine type.
6. Quantity in nos.

Disclaimer: Information's, written and verbal are provided by HIC, relative to its products which it determines to be reliable & no liabilities of whatsoever nature in regards to its uses. The purchaser of UNIVERSAL brand industrial products should determine for itself the suitability of such products.



Contact For Quote:

HIC INTERNATIONAL CO -Motors Drive Tyre Coupling Div

D-136, Shankar Road, New Delhi - 110060, India

Phone: 91-11-6547 2400, 2874 5120

Fax: 91-11-2874 2791

E-mail : universal@hic-india.com; belts@universaldelhi.org

Website : <http://www.rubber-steel-industrial-products.com>

Key personnel : Mr. Anil Gupta, President



Industrial Machinery DRIVE Hitorque Alloy Steel Flexible Universal Gear Couplings



Flexible Coupling Technical Specification GEAR HIC Manufactured UNIVERSAL Brand

Universal Flexible Gear Couplings ensures trouble-free service for coupling needs, in way, the bush is having spherical shaped teeth and are precision machined to last for years and thus size of coupling must please be carefully done.

Flexible Coupling INDUSTRIAL MACHINERY Drive Product Specification

- Full Gear Greater Torque lovejoy interchangeable cranes -hoists couplings 1 to 12 sizes upto 570 mm Outer Diameter 240 mm maximum bore.
- Rigid Gear fenner interchangeable concrete mixers -diesel engines couplings 1 to 10 sizes upto 530 mm OD 190 mm max bore.

Gear Coupling Full Gear Type

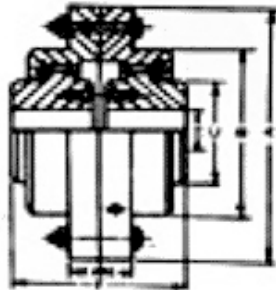

Rigid Coupling Half Gear Type

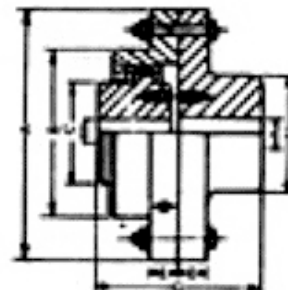

* Long Lasting
* Grease Lubricated

Contact For Quote:

HIC INTERNATIONAL CO. (Cast Iron Products Coupling Rubber Div.)

D-136, Shankar Road, New Delhi - 110060, India

Phone: 91-11-6547 2400, 2874 5120

Fax: 91-11-2874 2791

E-mail : universal@hic-india.com; belts@universaldelhi.org

Website : <http://www.rubber-steel-industrial-products.com>

Key personnel : Mr. Anil Gupta, President



**Industrial Machinery
DRIVE Hitorque
Alloy Steel Flexible
Universal Gear Couplings**



Full Geared Coupling

Half Geared-Half Rigid Coupling



Gear Coupling & Rigid Coupling (Dimension Details)

Coupling gear size	Couplings both				Gear Coupling					Rigid Coupling			
	Coupling drive torque Kg.M	Power per 100 rev/min KW	Power per 100 rev/min H.P.	Max. speed rev/min	Gear Coupling O.D A	E	B	C	F	H	D	G	Max bore
0-S	500	5.22	7	7000	150	16	90	50	105	30	60	107.5	40
1-S	100	10.44	14	6300	170	18	110	65	115	40	85	117.5	55
2-S	200	20.88	28	5000	185	18	125	90	145	55	110	147.5	70
3-S	430	44.76	60	4000	220	22	150	105	177	70	130	178.5	85
4-S	780	81.31	109	3300	250	22	180	125	219	85	160	219.5	100
5-S	1060	110.40	148	2800	290	25	205	150	245	105	190	242.5	120
6-S	1660	173.07	232	2500	320	25	235	170	265	120	215	262.5	140
7-S	2640	274.52	368	2130	350	25	265	200	315	140	245	312.5	160
8-S	3210	334.20	448	1900	380	25	295	230	365	160	280	367.5	180
9-S	4000	416.26	558	1700	430	28	330	250	445	180	310	412.5	200
10-S	6780	706.46	947	1420	490	28	390	310	495	220	360	492.5	225
11-S	10000	1041.41	1396	1250	545	30	445	350	555	260	415	557.5	270
12-S	13930	1450.97	1945	1100	590	30	490	400	620	290	480	620.5	310

*** Coupling Taper Lock also manufactured.**



Contact For Quote:

HIC INTERNATIONAL CO. (Cast Iron Products Coupling Rubber Div.)

D-136, Shankar Road, New Delhi - 110060, India

Phone: 91-11-6547 2400, 2874 5120

Fax: 91-11-2874 2791

E-mail : universal@hic-india.com; belts@universaldelhi.org

Website : <http://www.rubber-steel-industrial-products.com>

Key personnel : Mr. Anil Gupta, President



Industrial Machinery
DRIVE Hitorque
AlloySteel Flexible
Universal Gear Couplings



Gear Coupling Information To Be Supplied With Enquiry or Order

1. Motor H.P. rating i.e. 40 or 100 H.P. & so on.
2. R.P.M. at which coupling is to run i.e. 1100 or 5000 so on.
3. Bore size in mm i.e. 40 or 270mm & so on.
4. Coupling Type i.e. Full geared or Half geared Half rigid type.
5. O.D. in mm.
6. Machine type.
7. Quantity in nos.

Disclaimer: Information's, written and verbal are provided by HIC, relative to its products which it determines to be reliable & no liabilities of whatsoever nature in regards to its uses. The purchaser of UNIVERSAL brand industrial products should determine for itself the suitability of such products.



Contact For Quote:

HIC INTERNATIONAL CO. (Cast Iron Products Coupling Rubber Div.)

D-136, Shankar Road, New Delhi - 110060, India

Phone: 91-11-6547 2400, 2874 5120

Fax: 91-11-2874 2791

E-mail : universal@hic-india.com; belts@universaldelhi.org

Website : <http://www.rubber-steel-industrial-products.com>

Key personnel : Mr. Anil Gupta, President



Machinery Motors Flexible Bush Coupling Technical Specifications



Flexible Coupling Technical Specification PIN BUSH HIC Manufactured UNIVERSAL Brand

Universal Pin Bush Couplings ensures high torque transmissions at high speeds, in a way, coupling have remarkable shock absorption capacity due to construction being cushioned drive type transmitting the torque through rubber bushes, unaffected by water, dust and atmospheric conditions permits drive in either direction requiring no lubrication and no adjustment after fitting.



Shaft Coupling HEAVY MACHINERY Drive Product Specification

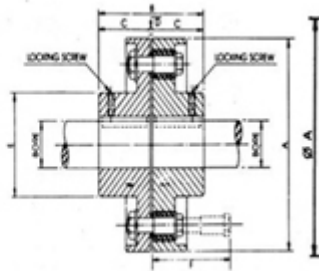

Contact For Quote:

HIC INTERNATIONAL CO -Cast Iron Products Flexible Coupling Div

D-136, Shankar Road, New Delhi - 110060, India

Phone: 91-11-6547 2400, 2874 5120

Fax: 91-11-2874 2791

E-mail : universal@hic-india.com; belts@universaldelhi.org

Website : <http://www.rubber-steel-industrial-products.com>

Key personnel : Mr. Anil Gupta, President



Machinery Motors Flexible Bush Coupling Technical Specifications



Coupling Bush Size	No. of Pins	Coupling Min. Bore	Coupling Max Bore	A	B	C	D	E	F	Coupling Drive Torque Kg. M.	Motor Power per 100 REV/MIN KW	Power per 100 REV/MIN H.P.	Drive Max. Speed REV/MIN
1 B	3	12.7	28	95	79	38	3	44	58	7.84	0.81	1.09	6000
2 B	4	12.7	30	114	99	48	3	51	70	31.60	3.29	4.41	5000
2A B	6	16.0	42	130	105	51	3	68	70	52.59	5.47	7.34	4300
3 B	4	16.0	48	160	125	60	5	75	114	63.30	6.59	8.84	3500
4 B	4	20.0	65	191	145	70	5	105	114	84.70	8.81	11.82	2900
4A B	6	20.0	65	191	145	70	5	105	114	126.50	13.17	17.66	2900
5 B	6	25.0	75	225	157	76	5	120	114	169.41	17.65	23.66	2500
6 B	8	45.0	95	254	183	89	5	152	114	240.46	25.05	33.58	2200
6A B	10	45.0	95	254	183	89	5	152	114	298.87	31.13	41.74	2200
6B B	12	45.0	95	254	183	89	5	152	114	360.14	37.51	50.29	2200
7 B	12	45.0	115	290	235	115	5	185	114	423.44	44.11	59.13	1900
7A B	14	60.0	120	300	235	115	5	192	130	529.56	55.17	73.96	1850
8 B	16	65.0	130	310	255	125	5	208	130	592.86	61.76	82.80	1800
8A B	18	65.0	135	340	265	130	5	216	130	740.87	77.18	103.47	1600
8B B	12	70.0	140	360	276	135	6	224	200	889.80	92.70	124.27	1540
9 B	13	80.0	150	390	316	155	6	240	200	1012.43	105.48	141.40	1420
9A B	15	90.0	160	410	336	165	6	256	200	1353.10	140.97	188.98	1350
10 B	16	100.0	170	440	366	180	6	272	200	1469.92	153.15	205.29	1250
10A B	17	110.0	180	480	386	190	6	288	212	1839.95	191.70	256.97	1150
11 B	20	120.0	190	530	406	200	6	305	212	2424.05	252.56	338.55	1030

All dimension in mm

* Coupling Taper Lock also manufactured upto size B7A



Contact For Quote:

HIC INTERNATIONAL CO -Cast Iron Products Flexible Coupling Div

D-136, Shankar Road, New Delhi - 110060, India

Phone: 91-11-6547 2400, 2874 5120

Fax: 91-11-2874 2791

E-mail : universal@hic-india.com; belts@universaldelhi.org

Website : <http://www.rubber-steel-industrial-products.com>

Key personnel : Mr. Anil Gupta, President



Machinery Motors Flexible Bush Coupling Technical Specifications



Bush Coupling Information To Be Supplied With Enquiry or Order

1. Coupling size no. i.e., B1 or B3 & so on.
2. No. of Pins i.e. 3 or 4 & so on.
3. Specific bore size in mm.
4. Pin bush coupling with quick-fit taper bush system required or regular tape.
5. Application details.
6. Quantity in nos.

Disclaimer: Information's, written and verbal are provided by HIC, relative to its products which it determines to be reliable & no liabilities of whatsoever nature in regards to its uses. The purchaser of UNIVERSAL brand industrial products should determine for itself the suitability of such products.



Contact For Quote:

HIC INTERNATIONAL CO -Cast Iron Products Flexible Coupling Div

D-136, Shankar Road, New Delhi - 110060, India

Phone: 91-11-6547 2400, 2874 5120

Fax: 91-11-2874 2791

E-mail : universal@hic-india.com; belts@universaldelhi.org

Website : <http://www.rubber-steel-industrial-products.com>

Key personnel : Mr. Anil Gupta, President