



Transmission Belts Machinery Drive Technical Specifications



Rubber Belting Technical Specification CANVAS FABRIC HIC Manufactured UNIVERSAL Brand

Flat type rubber transmission beltings are used for pulley to pulley power transmission in textile mills, flour mills, stone crushers threshers, rice mills, agriculture and other industrial usage and Universal offers high grade rubber compounded belt with pre-stretched fabric of great tensile strength to give trouble-free service.

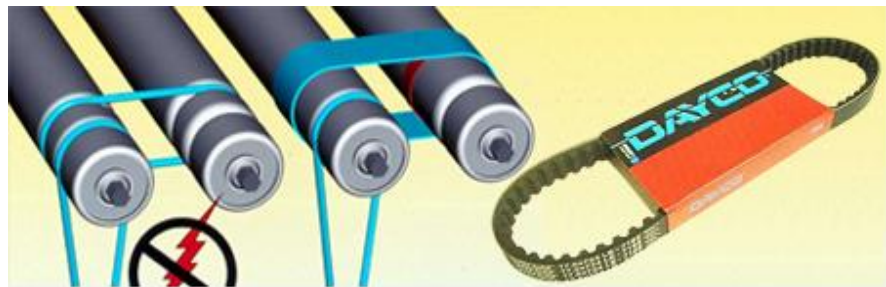

Power Transmission hic Flat Belting

- Rubber Nylon FR sandwich flat textile machinery belt 1.25mm thick green black colour upto 300 mm Width.
- Tangential rubber nylon textile mills belts TA 1.25~2.8mm thick green yellow colour upto 300 mm W.
- Leather belting cone drum drive LL 3~8mm thick off white chrome leather upto 300 mm W.
- Leather nylon paper mills line shaft drive belting LF 2.5~5.5mm thick upto 300 mm W.
- Nylon elastomer friction coating circular looms power transmission belts FF 1mm thick upto 300 mm W.
- PVC Nylon DB motorized tread mill and jogger machine belts 1.3~2.5mm thick upto 2000 mm W.
- Rubberized Nylon XRT textile carding drive motors belts 2~3.9mm thick upto 900 mm W.

Contact For Quote:

HIC INTERNATIONAL CO –Power Transmission Products Rubber Belting Div

D-136, Shankar Road, New Delhi - 110060, India

Phone: 91-11-6547 2400, 2874 5120

Fax: 91-11-2874 2791

E-mail : universal@hic-india.com; belts@universaldelhi.org

Website : <http://www.rubber-steel-industrial-products.com>

Key personnel : Mr. Anil Gupta, President



Transmission Belts Machinery Drive Technical Specifications



- Spindle Tapes ST folder and carrier belts.
- Friction surface train lighting belting 3~5 ply 31 -34 oz duck upto 1050 mm W.
- Canvas Rubber agricultural machinery drive belts 4~5 ply 28 -31 oz quality upto 1050 mm W.
- Transmission Rubber belts stone crushers, balata, flour mills motor drive 4~10 ply 37-34-31 oz upto 1050 mm W.

Rubber Belting FLAT Product Specification

(Superseding BS:351 and IS:1370)

Rubber Belt Quality Type	Belting Industrial Brands	#Drive Belt Edge Construction	~Transmission Belting Widths (mm)	*Belts Colour	~Belting Ply	App. Wt. Per 25mm=1' per ply per meter
Qte Type	Marque	#Construction de dentelle	~Largeur	*Couleur	~Toron	Poid de courroie par 25mm de largeur par toron/m
Tipo de Calidad	Marcas	#Borde construccion	~Anchura + (mm)	*Color Acero	~Travesias	Peso de cinta(aprox.)
1. 28oz light duty	Universal Super	Cut	25, 31, 37, 50, 62, 75, 88, 100	light grey With blue sides	3,4,5	0.037
2. 31oz medium duty	i) Universal Kinetic ii) Tor Steel iii) Tusker Super Deluxe	Cut	25, 31, 37, 50, 62, 75, 88, 100, 125, 150, 175, 200	do	3,4,5,6	0.038
3. 34oz heavy duty	i) Universal Oak ii) Dynapower iii) Cannon	Cut	37, 50, 62, 75, 88, 100, 125, 150, 175, 200, 225, 250, 150, 175, 200, 250, 300	do	4,5,6 8	0.040
4. 37oz extra heavy duty exclusively mfd. to our standards	i) Universal Brute ii) Rhino (super tough quality)	Cut	75, 100, 125, 150, 200, 250, 150, 200, 250, 300, 350, 400	do	4,5,6 8,10,12	0.045
5. 31oz Black medium to high duty	i) Universal Black Belt ii) Black Stone (with 0.4 mm app. thick black rubber coating on face & bottom frictioned)	Cut	75, 100, 125, 150	black	4	0.045



Contact For Quote:

HIC INTERNATIONAL CO –Power Transmission Products Rubber Belting Div

D-136, Shankar Road, New Delhi - 110060, India

Phone: 91-11-6547 2400, 2874 5120

Fax: 91-11-2874 2791

E-mail : universal@hic-india.com; belts@universaldelhi.org

Website : <http://www.rubber-steel-industrial-products.com>

Key personnel : Mr. Anil Gupta, President



Transmission Belts Machinery Drive Technical Specifications



Round edge construction with red stripe in middle are also manufactured in 28oz, 31oz duck quality, types subject to min. quantity of orders are placed as required at higher charges than cut edge for which please refer to us.

* **Other colours** are also manufactured, like orange (TBS) with red sides or light green with green sides on little extra charges subject to min. quantities of orders are placed.

~**Widths and plies** not listed above can be manufactured to order ranging sizes from # 25mm to 1050mm widths & 2 ply to 14 ply. Tolerance in width of +, - 3mm shall be applicable upto 125mm; +, - 4mm above 125mm upto 300mm; +, - 5mm above 300mm & upto 500mm; +, - 10mm above 500 & upto 750 ; +, - 15mm above 750 mm & up to 1050 mm widths.

MINIMUM RECOMMENDED BELT FLAT PULLEY DIAMETERS (in mm)

Belting Number of Plies	Belt speed (mtrs/sec.)				
Nombre de torons	Vitesse de courroie (metres/sec.)				
Numero de travesias	Velocidad de cintas (metros/seg.)				
	10	15	20	25	30
3	90	100	112	140	180
4	140	160	180	200	250
5	200	225	250	315	355
6	250	315	355	400	450
7	355	400	450	500	560
8	450	500	560	630	710
10	630	710	800	900	1000

RECOMMENDED BELT DRIVE FLAT PULLEY WIDTHS

Belt Width	Pulley to be wider than the belt width by
Largeur de courroie	Poulie doit etre plus large que courroie par
Anchura de	Cinta Polea a ser mas ancha que la anchura de la cinta por
Upto and including 125 mm	15mm
From 125 mm upto & incl. 250 mm	25mm
From 250 mm upto & incl. 375 mm	40mm
From 375 mm upto & incl. 500 mm	50mm

DIRECT DRIVE BELT CLIPPER FASTENERS

While vulcanized splices i.e., endless belt is strongly recommended but whenever it is not convenient to use endless belts, then wire hook-joints/sheet steel stampings/strap or plate joints may please be used, Please refer for fitting to the fasteners manufacturer/supplier for suitable selection.



Contact For Quote:

HIC INTERNATIONAL CO –Power Transmission Products Rubber Belting Div

D-136, Shankar Road, New Delhi - 110060, India

Phone: 91-11-6547 2400, 2874 5120

Fax: 91-11-2874 2791

E-mail : universal@hic-india.com; belts@universaldelhi.org

Website : <http://www.rubber-steel-industrial-products.com>

Key personnel : Mr. Anil Gupta, President



Transmission Belts Machinery Drive Technical Specifications



UNIVERSAL NYLON TRANSMISSION BELTINGS TECHNICAL SPECIFICATIONS

Type	Total thickness (mm)		Weight (Kg/sq. mtr) Approx		Min. Pulley dia (mm)		Pull for 1% Elongation (kg/cm)		Tensile Strength (kgs/cm)		Top Surface			Driving Surface			Max. temp. resistance (oc)								
											Col.	Mat.	COF	Col.	Mat.	COF									
LEATHER NYLON BELTINGS												RUBBER NYLON BELTINGS													
LL-3	3.6	3.4	20	2	60	W	L	0.4	W	L	0.4	80	AR-1	2.4	3.0	40	4	120	G	NR	0.7	G	NR	0.7	100
LL-6	4.0	3.7	40	4	120	W	L	0.4	W	L	0.4	80	AR-2	2.6	3.3	80	8	240	G	NR	0.7	G	NR	0.7	100
LL-10	4.4	4.2	80	8	240	W	L	0.4	W	L	0.4	80	AR-3	2.9	3.6	100	10	330	G	NR	0.7	G	NR	0.7	100
LL-12	5.0	4.6	100	10	330	W	L	0.4	W	L	0.4	80	AR3/6	6.0	6.7	100	10	330	G	NR	0.7	G	NR	0.7	100
LL-20	6.5	5.5	160	16	480	W	L	0.4	W	L	0.4	80	AR-4	3.3	4.2	160	16	480	G	NR	0.7	G	NR	0.7	100
LL-30	7.5	6.7	240	24	720	W	L	0.4	W	L	0.4	80	AR-5	3.9	4.6	220	19	570	G	NR	0.7	G	NR	0.7	100
LL-40	8.0	7.8	320	32	960	W	L	0.4	W	L	0.4	80	ARS-1	2.4	3.0	40	4	120	G	NR	0.7	Y	NR	0.7	100
LL-50	10	8.9	400	40	1200	W	L	0.4	W	L	0.4	80	ARS-2	2.6	3.3	80	8	240	G	NR	0.7	Y	NR	0.7	100
LF-3	2.2	2.0	20	2	60	R	F	0.3	W	L	0.4	80	ARS-3	2.9	3.6	100	10	330	G	NR	0.7	Y	NR	0.7	100
LF-6	2.4	2.3	40	4	120	R	F	0.3	W	L	0.4	80	ARS-4	3.3	4.2	160	16	480	G	NR	0.7	Y	NR	0.7	100



Contact For Quote:

HIC INTERNATIONAL CO –Power Transmission Products Rubber Belting Div

D-136, Shankar Road, New Delhi - 110060, India

Phone: 91-11-6547 2400, 2874 5120

Fax: 91-11-2874 2791

E-mail : universal@hic-india.com; belts@universaldelhi.org

Website : <http://www.rubber-steel-industrial-products.com>

Key personnel : Mr. Anil Gupta, President



Transmission Belts Machinery Drive Technical Specifications



UNIVERSAL NYLON TRANSMISSION BELTINGS TECHNICAL SPECIFICATIONS

Type	Total thickness (mm)	Weight (Kg/sq. mtr) Approx	Min. Pulley dia (mm)	Pull for 1% Elongation (kg/cm)	Tensile Strength (kgs/cm)	Top Surface	Driving Surface	Max. temp. resistance (oc)	Type	Total thickness (mm)	Weight (Kg/sq. mtr) Approx	Min. Pulley dia (mm)	Pull for 1% Elongation (kg/cm)	Tensile Strength (kgs/cm)	Top Surface	Driving Surface	Max. temp. resistance (oc)		
LF-10	3.1	2.8	80	8	240	R F	0.3 W L	0.4	80	TANGENTIAL BELTS									
LF-12	3.4	3.5	100	10	330	R F	0.3 W L	0.4	80	TA 15M	1.8	2.0	50	5	150	PG NR	0.7 B NR	0.7	100
LF-20	4.8	4.0	160	16	480	R F	0.3 W L	0.4	80	TA 16M	1.8	2.1	50	5	150	PG NR	0.7 B NR	0.7	100
LF-30	6.0	4.5	240	24	720	R F	0.3 W L	0.4	80	TA 24M	2.4	3.0	100	10	300	PG NR	0.7 B NR	0.7	100
LF-30	7.3	6.3	320	32	960	R F	0.3 W L	0.4	80	TA 24MS	3.0	3.7	100	10	300	PG NR	0.7 B NR	0.7	100
LF-50	8.5	7.3	400	40	1200	R F	0.3 W L	0.4	80	TA 29HX	3.2	3.9	150	15	450	PG NR	0.7 B NR	0.7	100
L-6	2.0	2.2	40	4	120	T PS	0.2 W L	0.4	80	TA 29HXS	4.0	5.1	150	15	450	PG NR	0.7 B NR	0.7	100



Contact For Quote:

HIC INTERNATIONAL CO –Power Transmission Products Rubber Belting Div

D-136, Shankar Road, New Delhi - 110060, India

Phone: 91-11-6547 2400, 2874 5120

Fax: 91-11-2874 2791

E-mail : universal@hic-india.com; belts@universaldelhi.org

Website : <http://www.rubber-steel-industrial-products.com>

Key personnel : Mr. Anil Gupta, President



Transmission Belts Machinery Drive Technical Specifications



UNIVERSAL NYLON TRANSMISSION BELTINGS TECHNICAL SPECIFICATIONS

Type	Total thickness (mm)	Weight (Kg/sq. mtr) Approx	Min. Pulley dia (mm)	Pull for 1% Elongation (kg/cm)	Tensile Strength (kgs/cm)	Top Surface	Driving Surface	Max. temp. resistance (oc)	Type	Total thickness (mm)	Weight (Kg/sq. mtr) Approx	Min. Pulley dia (mm)	Pull for 1% Elongation (kg/cm)	Tensile Strength (kgs/cm)	Top Surface	Driving Surface	Max. temp. resistance (oc)								
L-12	2.8	2.8	100	10	330	T	PS	0.2	W	L	0.4	80	SPINDLE TAPES												
L-16	3.9	3.4	160	16	480	T	PS	0.2	W	L	0.4	80	ST-0	0.7	0.5	10	0.5	20	B	F	0.20	W	F	0.20	80
LR-6	5.7	6.6	40	4	120	G	NR	0.7	W	L	0.4	80	ST-3	0.8	0.6	10	1	30	B	F	0.20	W	F	0.20	80
LR-10	4.2	4.1	80	8	240	G	NR	0.7	W	L	0.4	80	ST-6	0.9	0.7	20	2	60	B	F	0.20	W	F	0.20	80
LR-12	4.5	4.5	100	10	330	G	NR	0.7	W	L	0.4	80	WW-3	0.7	0.55	10	1	30	W	F	0.20	W	F	0.20	80

Contact For Quote:

HIC INTERNATIONAL CO –Power Transmission Products Rubber Belting Div

D-136, Shankar Road, New Delhi - 110060, India

Phone: 91-11-6547 2400, 2874 5120

Fax: 91-11-2874 2791

E-mail : universal@hic-india.com; belts@universaldelhi.org

Website : <http://www.rubber-steel-industrial-products.com>

Key personnel : Mr. Anil Gupta, President



Transmission Belts Machinery Drive Technical Specifications



UNIVERSAL NYLON TRANSMISSION BELTINGS TECHNICAL SPECIFICATIONS

Type	Total thickness (mm)	Weight (Kg/sq. mtr) Approx	Min. Pulley dia (mm)	Pull for 1% Elongation (kg/cm)	Tensile Strength (kgs/cm)	Top Surface	Driving Surface	Max. temp. resistance (oc)	Type	Total thickness (mm)	Weight (Kg/sq. mtr) Approx	Min. Pulley dia (mm)	Pull for 1% Elongation (kg/cm)	Tensile Strength (kgs/cm)	Top Surface	Driving Surface	Max. temp. resistance (oc)								
FABRIC NYLON BELTING									WW-6	0.8	0.65	20	2	60	W	F	0.20	W	F	0.20	80				
FF-0	0.6	0.4	10	0.5	20	R	F	0.25	R	F	0.25	80	WW-6	1.5	1.05	20	2	60	W	F	0.20	W	F	0.20	80
FF-3	0.8	0.6	20	2	60	R	F	0.25	R	F	0.25	80	WW-8	1.0	0.9	40	4	120	W	F	0.20	W	F	0.20	80
FF-6	1.0	0.9	40	4	120	R	F	0.25	R	F	0.25	80	CONDENSOR TAPES												
FF-10	1.5	1.4	80	8	240	R	F	0.25	R	F	0.25	80	Astra	3.2	2.8	40	4	120	BR	L	0.4	BR	L	0.4	80
FRI	1.6	1.4	50	4	120	R	F	0.25	G	F	0.7	80	Coriatex	3.2	3.2	40	4	120	BR	L	0.4	BR	L	0.4	80

Contact For Quote:

HIC INTERNATIONAL CO –Power Transmission Products Rubber Belting Div

D-136, Shankar Road, New Delhi - 110060, India

Phone: 91-11-6547 2400, 2874 5120

Fax: 91-11-2874 2791

E-mail : universal@hic-india.com; belts@universaldelhi.org

Website : <http://www.rubber-steel-industrial-products.com>

Key personnel : Mr. Anil Gupta, President



Transmission Belts Machinery Drive Technical Specifications



DISCRIPTION

Col	- Colour	B	- Black	Tolerance	101 - 500 mm 3 mm 501 - 750 mm 10 mm 751 - 950 mm 15 mm
MAT	- Material	BR	- Brown	Length	500 - 5000 mm $\pm 0.5\%$ 5001 - 15000 mm $\pm 0.3\%$ 150001 & Abv $\pm 0.2\%$
COF	- Coefficient of friction	Y	- Yellow	Width	Upto 50 mm ± 1 mm 51 - 100 mm ± 2 mm
W	- White	L	- Leather	Thickness	Rubber Series 0.15 mm Leather Series 0.3 mm ST/FF Series 0.05 mm
R	- Red	F	- Fabric		
T	- Transparent	PS	- Polyamide Strip		
G	- Green	NR	- Nitrile Rubber		
PG	- Parrot Green				

BASIC STRUCTURE



Contact For Quote:

HIC INTERNATIONAL CO –Power Transmission Products Rubber Belting Div
 D-136, Shankar Road, New Delhi - 110060, India
Phone: 91-11-6547 2400, 2874 5120
Fax: 91-11-2874 2791
E-mail : universal@hic-india.com; belts@universaldelhi.org
Website : <http://www.rubber-steel-industrial-products.com>
Key personnel : Mr. Anil Gupta, President



Transmission Belts Machinery Drive Technical Specifications



CHECK LIST FOR PROPER INDUSTRIAL BELTING MAINTENANCE

- New belts are stored in a cool, dry and well ventilated place.
- Belts are jointed with correct & suitable fasteners.
- Belt dressing is not used.
- Belts are kept clean free from oil and grease on pulley faces.

BELTINGS LENGTHS MANUFACTURED, ORDER QUANTITIES AND PACKING

- Belts are supplied in roll lengths of 100 meters in each size subject to length tolerance of + 12%, -2% in running lengths & billing is done in terms of actual length.
- Min. quantity acceptable are 1200 meters in one quality type & in 1 type of ply rating but may have different sizes (widths) due to manufacturing requirements.
- Packed in polythene and then further packed in sea worthy jute cloth.

Transmission Belts Information To Be Supplied With Enquiry or Order

1. Width of belt (mm)
2. Ply (Nos) / Thickness
3. Quality of Fabric / Belt Type (nylon or rubber or leather) & Application
4. Color of Belt (generally Grey / Green, else specify)
5. Length of Roll (mtrs) sub. to tol. +10%, -2% or Endless Size & Qty.

Disclaimer: Information's, written and verbal are provided by HIC, relative to its products which it determines to be reliable & no liabilities of whatsoever nature in regards to its uses. The purchaser of UNIVERSAL brand industrial products should determine for itself the suitability of such products.



Contact For Quote:

HIC INTERNATIONAL CO –Power Transmission Products Rubber Belting Div

D-136, Shankar Road, New Delhi - 110060, India

Phone: 91-11-6547 2400, 2874 5120

Fax: 91-11-2874 2791

E-mail : universal@hic-india.com; belts@universaldelhi.org

Website : <http://www.rubber-steel-industrial-products.com>

Key personnel : Mr. Anil Gupta, President



Motors Drive Industrial V-Belts Technical Specifications



V Belt Technical Specification POLYESTER CORD Neoprene Jacketed HIC Manufactured UNIVERSAL Brand

Universal V Belts ensures non-stop power transmission of electric motors drive with minimal stretch and anti-static oil-heat resistant quality, in a way, cords used are high tenacity polyester, jacket fabric rubberised with neoprene rubber and supersedes IS:2494, DIN 7753 and BS 2790 standards.



Motor V Belt



Cogged V Belt

Power Transmission hic V Belts

- Classical Sections A(13mm), B(17), C(22) upto 450 inches ; D(32), E(38) upto 600"; F(9.5), M(10), O(10), Z(10), K(8), FM(10.2) upto 150" ; 2L(6.5) , 3L(10) upto 50" ; 4L(13.2) upto 400".
- Wedge Space Saver sections SPZ(10), SPA(13), SPB(17) upto 490" ; SPC(22) upto 675".
- Double Hexagonal V Belts AA (12.7), BB (17), CC (22) upto 360".
- Narrow Size Hi-Power V Belts 3V (9.5), 5V (15.9), 8V (25.4) upto 470"; 9N (9), 10N (10), 15N (15), 25N (25) upto 575".
- Raw Edge Cogged v belts AX(13), BX(17), CX(22) upto 120" ; 3VX(9.5), 5VX(16.5) upto 70" ; XPZ(9.7), XPA(12.7), XPB(16.3), XPC(22) upto 120".
- Multiple Banded belts 2 to 6 bands cross sections RA(13), RB(17), RC(22), RD(32) upto 8890 mm.
- Narrow V Banded belts 2 to 8 bands sizes R3V (9.5), R5V (16.9), R8V (25.4), SPZ (10), SPA (13), SPB (17), SPC (22) upto 8000 mm.
- Poly V belts sizes 3PK, 4PK, 5PK, 6PK, 7PK, 8PK upto 2500 mm length.
- Wrapped and Cogged Combine Harvester belts 19X, 25X, 28X, 32X, 36X, 38X, 40X, 45X, 50X, 55X, 60X upto 4000 mm.
- Variable Speed Wrapped and Cogged belts sections HI(25), HJ(36), HK(40), HL(45), HM(50), HN(55) upto 180" ; VK(15), VM(20), VA(25), VB(31), VC(41), VD(52), VE(66), VF(76), VG(87) upto 105".

Contact For Quote:

HIC INTERNATIONAL CO -Vee / Fan Belts Power Transmission Product Div

D-136, Shankar Road, New Delhi - 110060, India

Phone: 91-11-6547 2400, 2874 5120

Fax: 91-11-2874 2791

E-mail : universal@hic-india.com; belts@universaldelhi.org

Website : <http://www.rubber-steel-industrial-products.com>

Key personnel : Mr. Anil Gupta, President



Motors Drive Industrial V-Belts Technical Specifications



LENGTH CODING SYSTEM: When the code number 50 is shown on the cello-tape affixed on each Poly V-Belt, this indicates that the actual length coincides with the nominal length printed on the belt. Each deviation of 2.5 mm from the nominal length is represented by one unit. For instance, a V-belt with size 100" coded 50 is exactly 100 inches inside length. If the code is 49, then it is 99.9" and if the code is 51, then it is 100.1" inside length.

MATCHED SETS: The question of matched sets arises in case of multi V-belt drive as the length of V-belt should be matched in order to obtain even distribution of load. A 'Matched Set' is simply a set of such belts, the length of which are within the specified limits, so that these can be used together.

The table as shown depicts the permissible length deviations in consecutive grading numbers marked near the size code which represents the exact length measured under specified operating tensions.

Belt Drive V Section	Belt Pitch Length Exceeds Inside Length By (mm)	V Belt Outside Diameter Exceeds Pitch Diameter By (mm)	Nominal Inside Length (mm) of Machine Belt	Range (inches) of V Belt	No. of consecutive grading number (s) to be used to make a matched set
A	36	6.6	457 to 1676	18-66	1
B	43	8.4	1702 to 2286	67-90	2
C	56	11.4	2311 to 3048	91-120	3
D	79	16.2	3073 to 4572	121-180	4
E	92	19.3	4597 to 9093	181-358	5
SPZ		4.0	9119 and above	359 and above	6
SPA		6.0			
SPB		7.0			
SPC		9.6			



Contact For Quote:

HIC INTERNATIONAL CO -Vee / Fan Belts Power Transmission Product Div

D-136, Shankar Road, New Delhi - 110060, India

Phone: 91-11-6547 2400, 2874 5120

Fax: 91-11-2874 2791

E-mail : universal@hic-india.com; belts@universaldelhi.org

Website : <http://www.rubber-steel-industrial-products.com>

Key personnel : Mr. Anil Gupta, President



Motors Drive Industrial V-Belts Technical Specifications



Power Transmission V-Belts Product Specification

Normal Horse Power H.P.	Speed of Faster Shaft i.e. Motor Speed RPM				V-Belt Section	Permissible Min. Belt Pulley Pitch Diameter		Recommended Min Belt Pulley Pitch Diameter	
	720 and below	900	1200	1800		mm	inch	mm	inch
1/2 to 1 ^{1/2}	A	A	A	A	A	75	3	95	3.8
2 to 3	A or B	A or B	A or B	A or B	B	125	5	145	5.8
5	A or B	A or B	A or B	A or B	C	200	8	225	9
10	A or B	A or B	A or B	A or B	D	315	12.6	350	14
15	C	B or C	B or C	B	E	500	20	550	22
20	C	C	C	B or C	SPZ	-	-	63	2.5
25 to 30	C	C	C	C	SPA	-	-	90	3.6
40	D	C or D	C or D	C	SPB	-	-	160	6.4
50	D	C or D	C or D	C or D	SPC	-	-	224	9.0
60	D	C or D	C or D	C or D					
75	D	C or D	C or D	C or D					

1 KW = H.P. X 0.746

Please note that with smaller pulley diameter than those recommended, the life of belt is reduced considerable and also the transmitting power decreases. It is necessary to ensure that at least belts run on pulleys that are not below the permissible minimum diameter for each section.



Contact For Quote:

HIC INTERNATIONAL CO -Vee / Fan Belts Power Transmission Product Div

D-136, Shankar Road, New Delhi - 110060, India

Phone: 91-11-6547 2400, 2874 5120

Fax: 91-11-2874 2791

E-mail : universal@hic-india.com; belts@universaldelhi.org

Website : <http://www.rubber-steel-industrial-products.com>

Key personnel : Mr. Anil Gupta, President



Motors Drive Industrial V-Belts Technical Specifications



Table 3 Standard V Belt Pulley DIMENSIONS

V Belt Groove Cross-Section	Pulley Pitch Diameter dp (mm)	Groove Angle A Degree + 0.5°	Minimum Top width of groove g (mm)	Minimum Groove depth below outside diameter hg (mm)	Centre to Centre of grooves Sg (mm)	Edge of Pulley of First Groove Centre (mm)
SPZ	Upto 80	34	9.7			
	Over 80	38	9.9	11.0	12 ± 0.3	8.0 ± 1.0
A	Upto 118	34	13.0			
SPA	Over 118	38	13.3	13.8	15 ± 0.3	10.0 ± 2.0
B	Upto 190	34	16.6			
SPB	Over 190	38	16.9	17.5	19 ± 0.4	-1.0
C	Upto 315	36	22.7	23.8	25.5 ± 0.4	12.5 ± 2.0
SPC	Over 315	38	22.9	23.8	25.5 ± 0.5	-1.0
D	Upto 475	36	32.2			
	Over 475	38	32.6			
E	Upto 630	36	38.3	28.0	37.0 ± 0.6	24.0 + .0
	Over 630	38	38.6	33.0	44.5 ± 0.7	-1.0
						29 + 4.0
						-1.0

When the Pulleys are to be used for V-belt sections, A, B or C only, dimension hg may be reduced by 20%

Universal urges to use standard premium quality Vee -Belt Pulley either conventional type or new generation quick - fit taper lock Pulley bush type manufactured to drag better mileage from V -Belts drive. Auto Fan Belts, Variable Speed Belts also manufactured.



Contact For Quote:

HIC INTERNATIONAL CO -Vee / Fan Belts Power Transmission Product Div

D-136, Shankar Road, New Delhi - 110060, India

Phone: 91-11-6547 2400, 2874 5120

Fax: 91-11-2874 2791

E-mail : universal@hic-india.com; belts@universaldelhi.org

Website : <http://www.rubber-steel-industrial-products.com>

Key personnel : Mr. Anil Gupta, President



Motors Drive Industrial V-Belts Technical Specifications



Vee Belt Information To Be Supplied With Enquiry or Order

(I) Section (II) Size in inches or mm (III) Quantity in nos.

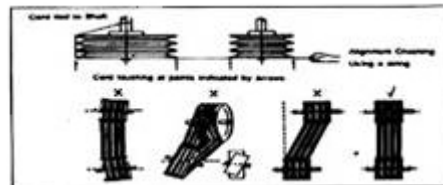
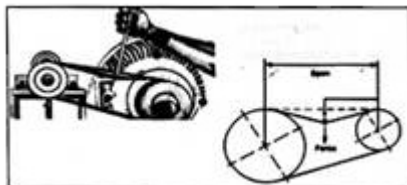

Belt Drive Rubber Design Formulae

$$L = 2C + 1.57(D + d) + \frac{(D-d)^2}{4C}$$

where

L = Belt Pitch Length mm
 C = Centre Distance mm
 D = Pitch dia of large pulley mm
 d = Pitch dia of small pulley mm

$$C = A + \sqrt{(A^2 - B)}$$

Where

$$A = \frac{L}{4} - 0.3925(D + d)$$

$$B = \frac{(D-d)^2}{8}$$

$$\text{Number of belts, } N = \frac{P \times F_s}{R \times F_l \times F_c}$$

R = Power Rating per belt KW
 Fl = Belt Length Connection factor
 Fc = Arc of contact correction Factor
 Fs = Service Factor
 P = Drive Power in KW

Narrow and Cogged V Belts Information To Be Supplied With Enquiry or Order

1. Section , Top width x Thickness
2. Size , Length inches I/C or Pitch Length - MM
3. Quantity , nos.

Disclaimer: Information's, written and verbal are provided by HIC, relative to its products which it determines to be reliable & no liabilities of whatsoever nature in regards to its uses. The purchaser of UNIVERSAL brand industrial products should determine for itself the suitability of such products.



Contact For Quote:

HIC INTERNATIONAL CO -Vee / Fan Belts Power Transmission Product Div

D-136, Shankar Road, New Delhi - 110060, India

Phone: 91-11-6547 2400, 2874 5120

Fax: 91-11-2874 2791

E-mail : universal@hic-india.com; belts@universaldelhi.org

Website : <http://www.rubber-steel-industrial-products.com>

Key personnel : Mr. Anil Gupta, President



Industrial Machinery Drive Quick Fit Taper-lock Cast-iron Universal Belt Pulleys



V Belt Pulley Technical Specification TAPER LOCK HIC Manufactured UNIVERSAL Brand

Universal V-Belt Pulleys ensures more mileage form V-belt drive(s), in a way, pulley is made from superior quality graded cast iron, with grooves property machined with or without dynamic balancing that saves time in fixing & removal, eliminates re-building or surface, re-boring & key -waying, avoids keeping inventory of pulleys interchangeability on many rotating items easier and possible and conforms to IS: 3142

Designed to have in-built facilities to maximize grips on shaft through wedging action on outer cone surface thus facilitating fixing and removal of bush easily through allen key.

Belts Rotation hic V Belts Pulleys



- Taper Lock Dynamically Balanced Dual Duty v belt pulleys A/SPA section 1 to 6 grooves 80~800mm pitch circle dia (pcd) or Outer Diameter ; B/SPB 1 to 6 belt grooves 125~1000 pcd ; C/SPC 2~10 belts run groove 200~1250mm pcd.
- Balanced General Purpose solid vbelt pulleys without taper bush A section 1 to 5 grooves 2~26 inch OD ; B section 1 to 5 grooves 2~40"od ; C section 3~8 belts groove 3~50" OD ; D section 3~12 belts groove 12~56" OD ; E section 5~15 belts groove 16~72" OD.
- Taper Lock Bushes weld on hubs sizes 1008 to 5050 upto 125 mm maximum bore size.
- Chain Sprockets wheels single-double strand with knob 10~50 teeth in sizes 3/8"-1/2"-5/8"-3/4"-1"-1-1/4"-1-1/2" pitch sizes.

Face Width Of Duo Applications Cone Bush Pulleys							
No. of V Belt Grooves							
Belt Section	2	3	4	5	6	7	8
A	35	50	65	80	-	-	-
B	44	63	82	101	120	-	-
C	-	-	111	136	162	187	213

Contact For Quote:

HIC INTERNATIONAL CO. (Cast Iron Products Pulley Div.)

D-136, Shankar Road, New Delhi - 110060, India

Phone: 91-11-6547 2400, 2874 5120

Fax: 91-11-2874 2791

E-mail : universal@hic-india.com; belts@universaldelhi.org

Website : <http://www.rubber-steel-industrial-products.com>

Key personnel : Mr. Anil Gupta, President



**Industrial Machinery
Drive Quick Fit
Taper-lock
Cast-iron Universal Belt
Pulleys**



Taper Lock Pulley Duo-Application QUICK FIT Cone Bush Product Specification

Industrial Pulley for use with A/SPA Section Belt					Industrial Pulley for use with A/SPA Section Belt					Industrial Pulley for use with A/SPA Section Belt																																																																																																																																																																																																																										
Pitch Dia	No. of Grooves	Bush No.	Max Bore	Pulley Type	Pitch Dia	No. of Grooves	Bush No.	Max Bore	Pulley Type	Pitch Dia	No. of Grooves	Bush No.	Max Bore	Pulley Type																																																																																																																																																																																																																						
80	2	1215	32	6	90	2	1615	42	3	100	2	1615	42	6																																																																																																																																																																																																																						
	3	1215	32	6		4	1210	32	6		5	1108	28	6	85	2	1215	32	6	95	2	1615	42	3	106	2	2012	50	6	3	1215	32	6	4	1210	32	6	5	1108	28	6	Industrial Pulley for use with A/SPA Section Belt					Industrial Pulley for use with A/SPA Section Belt					Industrial Pulley for use with B/SPB Section Belt					Pitch Dia	No. of Grooves	Bush No.	Max Bore	Pulley Type	Pitch Dia	No. of Grooves	Bush No.	Max Bore	Pulley Type	Pitch Dia	No. of Grooves	Bush No.	Max Bore	Pulley Type	112	2	1610	42	6	315	2	2517	60	4	180	2	2012	50	6	3	2012	50	6	4	2012	50	6	5	2012	50	6	118	2	1610	42	6	400	2	2517	60	4	190	2	2517	60	1	3	2012	50	6	4	2012	50	6	5	2012	50	6	125	2	1610	42	2	Industrial Pulley for use with B/SPB Section Belt					200	2	2517	60	1	3	2012	50	2	4	2012	50	2	5	2012	50	2	132	2	1610	42	2	Pitch Dia	No. of Grooves	Bush No.	Max Bore	Pulley Type	212	2	2517	60	1	3	2012	50	2	4	2517	60	2	5	2517	60	2	140	2	2012	50	6	125	2	1610	42	6	224	2	2517	60	1	3	2517	60	2	4	2517	60	2	5	2517	60	2																						
	4	1210	32	6		5	1108	28	6		85	2	1215	32		6	95	2	1615		42	3	106	2		2012	50	6	3	1215	32	6	4	1210	32	6	5	1108	28	6	Industrial Pulley for use with A/SPA Section Belt					Industrial Pulley for use with A/SPA Section Belt					Industrial Pulley for use with B/SPB Section Belt					Pitch Dia	No. of Grooves	Bush No.	Max Bore	Pulley Type	Pitch Dia	No. of Grooves	Bush No.	Max Bore	Pulley Type	Pitch Dia	No. of Grooves	Bush No.	Max Bore	Pulley Type	112		2	1610	42	6		315	2	2517	60		4	180	2	2012	50	6	3	2012	50	6	4	2012	50	6	5	2012		50	6	118	2		1610	42	6	400		2	2517	60	4	190	2	2517	60	1	3	2012	50	6	4	2012	50		6	5	2012	50							6	125	2	1610	42	2	Industrial Pulley for use with B/SPB Section Belt					200	2	2517	60	1		3	2012	50	2							4	2012	50	2	5	2012	50	2	132	2	1610	42	2	Pitch Dia	No. of Grooves	Bush No.		Max Bore	Pulley Type	212	2		2517	60	1	3		2012	50	2	4	2517	60	2	5	2517	60	2	140	2	2012	50	6	125	2	1610	42	6	224	2	2517	60	1	3	2517	60	2	4	2517	60	2	5	2517	60	2
	5	1108	28	6																																																																																																																																																																																																																																
85	2	1215	32	6	95	2	1615	42	3	106		2	2012	50		6																																																																																																																																																																																																																				
	3	1215	32	6		4	1210	32	6			5	1108	28	6	Industrial Pulley for use with A/SPA Section Belt					Industrial Pulley for use with A/SPA Section Belt					Industrial Pulley for use with B/SPB Section Belt					Pitch Dia	No. of Grooves	Bush No.	Max Bore	Pulley Type	Pitch Dia	No. of Grooves	Bush No.	Max Bore	Pulley Type	Pitch Dia	No. of Grooves	Bush No.	Max Bore	Pulley Type	112	2	1610	42	6	315	2	2517	60	4	180	2	2012	50	6	3	2012	50	6	4	2012	50	6	5	2012		50	6	118	2	1610	42		6	400	2	2517	60		4	190	2	2517	60	1	3	2012	50	6	4	2012	50	6	5	2012	50		6	125	2	1610	42		2	Industrial Pulley for use with B/SPB Section Belt					200	2	2517	60	1	3	2012	50	2	4	2012	50	2	5	2012	50	2	132	2	1610	42	2	Pitch Dia		No. of Grooves	Bush No.	Max Bore	Pulley Type							212	2	2517	60	1	3	2012	50	2	4	2517	60	2	5	2517	60	2	140	2	2012	50	6	125		2	1610	42	6				224				2	2517	60	1	3	2517	60	2	4	2517	60	2	5	2517	60	2																													
	4	1210	32	6		5	1108	28	6		Industrial Pulley for use with A/SPA Section Belt					Industrial Pulley for use with A/SPA Section Belt					Industrial Pulley for use with B/SPB Section Belt					Pitch Dia	No. of Grooves	Bush No.	Max Bore	Pulley Type	Pitch Dia	No. of Grooves	Bush No.	Max Bore	Pulley Type	Pitch Dia	No. of Grooves	Bush No.	Max Bore	Pulley Type	112	2	1610	42	6		315	2	2517	60		4	180	2	2012		50	6	3	2012	50	6	4	2012	50	6	5	2012	50	6	118	2	1610		42	6	400	2	2517		60	4	190	2	2517		60	1	3	2012	50	6	4	2012	50	6	5	2012	50	6	125	2	1610		42	2	Industrial Pulley for use with B/SPB Section Belt									200	2	2517	60	1	3	2012	50	2	4	2012	50	2	5	2012	50		2	132	2	1610		42					2	Pitch Dia	No. of Grooves	Bush No.	Max Bore	Pulley Type		212	2	2517	60	1	3	2012	50	2	4	2517	60	2	5	2517	60		2	140	2	2012		50	6	125	2	1610	42	6	224		2	2517	60	1	3	2517	60	2	4	2517	60	2	5	2517	60	2																																
	5	1108	28	6																																																																																																																																																																																																																																
Industrial Pulley for use with A/SPA Section Belt					Industrial Pulley for use with A/SPA Section Belt					Industrial Pulley for use with B/SPB Section Belt																																																																																																																																																																																																																										
Pitch Dia	No. of Grooves	Bush No.	Max Bore	Pulley Type	Pitch Dia	No. of Grooves	Bush No.	Max Bore	Pulley Type	Pitch Dia	No. of Grooves	Bush No.	Max Bore	Pulley Type																																																																																																																																																																																																																						
112	2	1610	42	6	315	2	2517	60	4	180	2	2012	50	6																																																																																																																																																																																																																						
	3	2012	50	6		4	2012	50	6		5	2012	50	6	118	2	1610	42	6	400	2	2517	60	4	190	2	2517	60	1	3	2012	50	6	4	2012	50	6	5	2012	50	6	125	2	1610	42	2	Industrial Pulley for use with B/SPB Section Belt					200	2	2517	60	1	3	2012	50	2	4	2012	50	2	5	2012	50	2	132	2	1610	42	2	Pitch Dia	No. of Grooves	Bush No.	Max Bore	Pulley Type	212	2	2517	60	1	3	2012	50	2	4	2517	60	2	5	2517	60	2	140	2	2012	50	6	125	2	1610	42	6	224	2	2517	60	1	3	2517	60	2	4	2517	60	2	5	2517	60	2																																																																																																										
	4	2012	50	6		5	2012	50	6		118	2	1610	42		6	400	2	2517		60	4	190	2		2517	60	1	3	2012	50	6	4	2012	50	6	5	2012	50	6	125		2	1610	42	2							Industrial Pulley for use with B/SPB Section Belt					200	2	2517	60	1	3	2012	50	2	4	2012		50	2	5	2012							50	2	132	2	1610	42	2	Pitch Dia	No. of Grooves	Bush No.	Max Bore	Pulley Type	212	2	2517	60		1	3	2012	50		2	4	2517	60		2	5	2517	60	2	140	2	2012	50	6	125	2	1610	42	6	224	2	2517	60	1	3	2517	60	2	4	2517	60	2	5	2517	60	2																																																																																										
	5	2012	50	6																																																																																																																																																																																																																																
118	2	1610	42	6	400	2	2517	60	4	190		2	2517	60		1																																																																																																																																																																																																																				
	3	2012	50	6		4	2012	50	6			5	2012	50	6	125		2	1610	42	2	Industrial Pulley for use with B/SPB Section Belt					200	2	2517	60	1	3	2012	50	2	4	2012	50	2	5		2012	50	2	132	2	1610	42	2	Pitch Dia	No. of Grooves	Bush No.							Max Bore	Pulley Type	212	2	2517	60	1	3	2012	50	2	4	2517	60	2	5	2517	60	2	140	2	2012	50		6	125	2	1610							42	6	224	2	2517	60	1	3	2517	60	2	4	2517	60	2	5	2517	60	2																																																																																																																					
	4	2012	50	6		5	2012	50	6		125	2	1610	42	2		Industrial Pulley for use with B/SPB Section Belt											200	2	2517	60	1	3	2012	50	2	4	2012	50	2	5	2012	50	2		132	2	1610	42				2	Pitch Dia	No. of Grooves	Bush No.	Max Bore	Pulley Type				212	2	2517	60	1	3	2012	50	2	4	2517	60	2	5	2517	60		2	140	2	2012	50		6	125	2	1610	42	6	224	2	2517	60		1	3	2517	60	2	4	2517	60	2	5	2517	60	2																																																																																																																								
	5	2012	50	6																																																																																																																																																																																																																																
125	2	1610	42	2	Industrial Pulley for use with B/SPB Section Belt					200		2	2517	60	1																																																																																																																																																																																																																					
	3	2012	50	2																																																																																																																																																																																																																																
	4	2012	50	2																																																																																																																																																																																																																																
	5	2012	50	2																																																																																																																																																																																																																																
132	2	1610	42	2	Pitch Dia	No. of Grooves	Bush No.	Max Bore	Pulley Type	212	2	2517	60	1																																																																																																																																																																																																																						
	3	2012	50	2																																																																																																																																																																																																																																
	4	2517	60	2																																																																																																																																																																																																																																
	5	2517	60	2																																																																																																																																																																																																																																
140	2	2012	50	6	125	2	1610	42	6	224	2	2517	60	1																																																																																																																																																																																																																						
	3	2517	60	2																																																																																																																																																																																																																																
	4	2517	60	2																																																																																																																																																																																																																																
	5	2517	60	2																																																																																																																																																																																																																																

Contact For Quote:

HIC INTERNATIONAL CO. (Cast Iron Products Pulley Div.)

D-136, Shankar Road, New Delhi - 110060, India

Phone: 91-11-6547 2400, 2874 5120

Fax: 91-11-2874 2791

E-mail : universal@hic-india.com; belts@universaldelhi.org

Website : <http://www.rubber-steel-industrial-products.com>

Key personnel : Mr. Anil Gupta, President



Industrial Machinery Drive Quick Fit Taper-lock Cast-iron Universal Belt Pulleys



Industrial Pulley for use with A/SPA Section Belt					Industrial Pulley for use with B/SPB Section Belt					Industrial Pulley for use with B/SPB Section Belt				
150	2	2012	50	6	132	2	1610	42	6	236	2	2517	60	1
	3	2517	60	2		3	1610	42	6		3	2517	60	2
	4	2517	60	2		4	2012	50	3		4	3020	75	2
	5	2517	60	2		5	2012	50	2		5	3020	75	2
					6	2012	50	3	6	3020	75	2		
160	2	2012	50	6	140	2	1610	42	6	250	2	2517	60	8
	3	2517	60	2		3	1610	42	6		3	3020	75	2
	4	2517	60	2		4	2012	50	3		4	3020	75	2
	5	2517	60	2		5	2012	50	2		5	3020	75	2
					6	2517	60	3	6	3020	75	2		
180	2	2012	50	2	150	2	1610	42	6	280	2	2517	60	8
	3	2517	60	2		3	2012	50	6		3	3020	75	7
	4	2517	60	2		4	2012	50	3		4	3020	75	7
	5	3020	75	2		5	2517	60	2		5	3535	90	7
					6	2517	60	2	6	3535	90	7		
200	2	2517	60	8	160	2	2012	50	6	315	2	3020	60	8
	3	2517	60	3		3	2517	60	6		3	3020	75	7
	4	3020	75	2		4	2517	60	3		4	3535	90	8
	5	3020	75	2		5	2517	60	3		5	3535	90	7
					6	2517	60	2	6	3535	90	7		
250	2	2517	60	8	170	2	2012	50	6	355	2	2517	75	4
	3	2517	60	7		3	2517	60	6		3	3020	75	5
	4	3020	75	7		4	2517	60	3		4	3535	90	8
	5	3020	75	7		5	3020	75	3		5	3535	90	7
					6	3020	75	2	6	3535	90	7		
Industrial Pulley for use with B/SPB Section Belt					Industrial Pulley for use with C/SPC Section Belt					Industrial Pulley for use with C/SPC Section Belt				
Pitch Dia	No. of Grooves	Bush No.	Max Bore	Pulley Type	Pitch Dia	No. of Grooves	Bush No.	Max Bore	Pulley Type	Pitch Dia	No. of Grooves	Bush No.	Max Bore	Pulley Type
400	2	3020	75	4	236	4	3535	90	3	425	4	3535	90	5
	3	3535	90	4		5	3535	90	3		5	4040	100	7
	4	3535	90	4		6	3535	90	3		6	4545	110	7
	5	3535	90	5		7	3535	90	3		7	4545	110	7
	6	3535	90	5		8	3535	90	3		8	5050	125	7
500	2	3020	75	4	250	4	3535	90	3	450	4	3535	90	5
	3	3535	90	4		5	3535	90	3		5	4040	100	5
	4	3535	90	4		6	3535	90	3		6	4545	110	7
	5	3535	90	5		7	3535	90	3		7	5050	125	7
	6	4040	100	5		8	3535	90	3		8	5050	125	7
630	2	3030	75	4	265	4	3535	90	3	475	4	3535	90	5
	3	3535	90	4		5	3535	90	3		5	4040	100	5
	4	3535	90	4		6	3535	90	3		6	4545	110	7
	5	4040	100	4		7	3535	90	3		7	5050	125	7
	6	4040	100	5		8	3535	90	3		8	5050	125	7

Contact For Quote:

HIC INTERNATIONAL CO. (Cast Iron Products Pulley Div.)

D-136, Shankar Road, New Delhi - 110060, India

Phone: 91-11-6547 2400, 2874 5120

Fax: 91-11-2874 2791

E-mail : universal@hic-india.com; belts@universaldelhi.org

Website : <http://www.rubber-steel-industrial-products.com>

Key personnel : Mr. Anil Gupta, President



Industrial Machinery Drive Quick Fit Taper-lock Cast-iron Universal Belt Pulleys



Industrial Pulley for use with B/SPB Section Belt					Industrial Pulley for use with C/SPC Section Belt					Industrial Pulley for use with C/SPC Section Belt				
800	2	3030	75	4	280	4	3535	90	3	500	4	3535	90	5
	3	3535	90	4		5	3535	90	3		5	4040	100	5
	4	4040	100	4		6	3535	90	3		6	4545	110	5
	5	4040	100	4		7	3535	90	3		7	5050	125	7
	6	4545	110	5		8	3535	90	3		8	5050	125	7
1000	3	4040	100	4	300	4	3535	90	7	530	4	4040	100	5
	4	4040	100	4		5	3535	90	7		5	4545	110	5
	5	4545	110	4		6	3535	90	7		6	5050	125	5
	6	4545	100	5		7	3535	90	7		7	5050	125	7
Industrial Pulley for use with C/SPC Section Belt					315	4	3535	90	7	560	4	4040	100	5
						5	3535	90	7		5	4545	110	5
						6	3535	90	7		6	5050	125	5
						7	3535	90	7		7	5050	125	5
200	4	3020	75	3	335	4	3535	90	7	630	4	4545	110	4
	5	3535	90	3		5	3535	90	7		5	5050	125	5
	6	3535	90	3		6	3535	90	7		6	5050	125	5
	7	3535	90	3		7	3535	90	7		7	5050	125	5
	8	3535	90	3		8	4040	100	3		8	5050	125	5
212	4	3020	75	3	355	4	3535	90	7	800	4	5050	125	4
	5	3535	90	3		5	3535	90	7		5	5050	125	5
	6	3535	90	3		6	3535	90	7		6	5050	125	5
	7	3535	90	3		7	4040	90	7		7	5050	125	5
	8	3535	90	3		8	4040	100	3		8	5050	125	5
224	4	3535	90	3	375	4	3535	90	7	1000	4	5050	125	4
	5	3535	90	3		5	3535	90	7		5	5050	125	5
	6	3535	90	3		6	4040	100	7		6	5050	125	5
	7	3535	90	3		7	4040	100	7		7	5050	125	5
	8	3535	90	3		8	4045	110	7		8	5050	125	5
280	4	3535	90	3	400	4	3535	90	5	1250	4	5050	125	4
	5	3535	90	3		5	3535	90	5		5	5050	125	5
	6	3535	90	3		6	4040	100	7		6	5050	125	5
	7	3535	90	3		7	4545	110	7		7	5050	125	5
	8	3535	90	3		8	4545	110	7		8	5050	125	5



Contact For Quote:

HIC INTERNATIONAL CO. (Cast Iron Products Pulley Div.)

D-136, Shankar Road, New Delhi - 110060, India

Phone: 91-11-6547 2400, 2874 5120

Fax: 91-11-2874 2791

E-mail : universal@hic-india.com; belts@universaldelhi.org

Website : <http://www.rubber-steel-industrial-products.com>

Key personnel : Mr. Anil Gupta, President



Industrial Machinery Drive Quick Fit Taper-lock Cast-iron Universal Belt Pulleys



Belt Pulley Taper Lock Bush Dimensions In Millimeters

Cone & Bush size	1008	1108	1210	1215	1310	1610	1615	2012	2517	2525	3020	3030	3535	3525	4040	4545	5050
Nominal dia at large end of cone	35.0	38.0	47.5	47.5	51.0	57.0	57.0	70.0	85.5	85.5	108.0	108.0	127.0	127.0	146.0	162.0	177.5
face width	22	22	25	38	25	25	38	32	45	65	51	76	65	89	102	114	127
minimum bore	9	9	11	11	14	14	14	14	16	19	25	35	48	35	40	55	70
maximum bore	25	28	32	32	35	42	42	50	60	80	75	75	90	90	100	110	125



Quick Fit Taper-lock
Pulley Bush



Universal Weld on Hub
Pulley Bush

V Belt PULLEY Standard

v Belt Groove Cross-Section	Pulley pitch Diameter dp (mm)	Groove Angle A Deree $\pm 0.5^\circ$	Minimum Top width of groove g (mm)	Minimum Groove depth below outside diameter hg (mm)	Centre to centre of grooves sg (mm)	Edge of Pulley to first Groove Centre (mm)
SPZ	upto 80 over 80	34 38	9.7 9.9	11.0	12+0.3	8.0+1.0
A	upto 118 over 118	34 38	13.0 13.3	13.8	15+0.3	10.0+2.0 -1.0
SPA	upto 190 over 190	34 38	16.6 16.9	17.5	19+0.4	12.5+2.0 -1.0
B	upto 315 over 315	34 38	22.7 22.9	23.8	25.5+0.5	17+2.0 -1.0
SPB	upto 475 over 475	36 38	32.2 32.6	28.0	37.0+0.6	24.0+3.0 -1.0
C	upto 630 over 630	36 38	38.3 38.6	33.0	44.5+0.7	29+4.0 -1.0
D						
E						

When the pulley are to be used for v-belt sections A, B or C only, dimension hg may be reduced by 20%



Contact For Quote:

HIC INTERNATIONAL CO. (Cast Iron Products Pulley Div.)

D-136, Shankar Road, New Delhi - 110060, India

Phone: 91-11-6547 2400, 2874 5120

Fax: 91-11-2874 2791

E-mail : universal@hic-india.com; belts@universaldelhi.org

Website : <http://www.rubber-steel-industrial-products.com>

Key personnel : Mr. Anil Gupta, President



Industrial Machinery Drive Quick Fit Taper-lock Cast-iron Universal Belt Pulleys



Dynamic Balancing of pulleys undertaken please and our lab Test Certificate is provided

Vee Belt Pulley Information To Be Supplied With Enquiry or Order

1. Size i.e. pulley pitch dia, whether 75mm or 125mm & so on.
2. No. of grooves i.e. 2, 3 & so on.
3. For V-belt section i.e. A or SPB & so on.
4. Type i.e. general purpose or quick-fit with taper lock bush.
5. Bore size i.e. pilot or some requisite size.
6. Key waying, if at all reqd. (length, width & depth).
7. Quantity in nos. 8. Your detailed drawing, if possible.

Disclaimer: Information's, written and verbal are provided by HIC, relative to its products which it determines to be reliable & no liabilities of whatsoever nature in regards to its uses. The purchaser of UNIVERSAL brand industrial products should determine for itself the suitability of such products.



Contact For Quote:

HIC INTERNATIONAL CO. (Cast Iron Products Pulley Div.)

D-136, Shankar Road, New Delhi - 110060, India

Phone: 91-11-6547 2400, 2874 5120

Fax: 91-11-2874 2791

E-mail : universal@hic-india.com; belts@universaldelhi.org

Website : <http://www.rubber-steel-industrial-products.com>

Key personnel : Mr. Anil Gupta, President



Motor-Generator Drive Flexible Tyre Couplings Technical Specifications



Rubber Coupling Technical Specification TYRE HIC Manufactured UNIVERAL Brand

Universal Tyre Couplings ensures **high torque transmitting capacity** in motor generators, etc in various industrial machines, in a way, the true **tyre material** is made from neoprene/ natural/synthetic rubber compounds reinforced with Rayon/ Nylon/ Polyester Cord to give superior rating & long durability, **bore size** is well matched to attain maximum speed (rpm) ensuring minimum to **nil slippage** of the **flexible** element out from the coupling assembly in case of any faulty installation.



Tyre Coupling

Rubber Coupling FLEXIBLE SHAFT Drive Product Specification

- TC-series Conventional rubber tyre unique interchangeable motor couplings 006 to 024 sizes upto 530 mm Outer Diameter 170 mm maximum bore and spare tyre.
- F series Multidirectional flexible rathi interchangeable tyre couplings 40 to 200 sizes upto 190 mm max bore and spare tyre.
- PH series New Generation flexible fenaflex interchangeable shaft couplings 96 to 450 sizes upto 175 mm max bore and spare tyre. Ease of use as no lubrication needed, absorbs big misalignment thus saves downtime.
- HRC-series fenner interchangeable flexible shaft cushi on couplings 090 to 280 sizes upto 115mm max bore and spare element.

Bore sizes : 6mm to 280mm
Speed (rev./min.) : From 500 to 7000 rpm.



Contact For Quote:

HIC INTERNATIONAL CO -Motors Drive Tyre Coupling Div

D-136, Shankar Road, New Delhi - 110060, India

Phone: 91-11-6547 2400, 2874 5120

Fax: 91-11-2874 2791

E-mail : universal@hic-india.com; belts@universaldelhi.org

Website : <http://www.rubber-steel-industrial-products.com>

Key personnel : Mr. Anil Gupta, President



Motor-Generator Drive Flexible Tyre Couplings Technical Specifications



Motor Coupling Dimension Details TC - series

Coupling tyre size	Tyre coupling max. bore mm	Max speed RPM	Count rating	Couplings approx. dimension (mm)				
			HP/100 RPM	Coupling tyre O.D. (A)	Coupling length (L)	Hub dia (D)	Flange length (E)	Gap bet. two flanges (M)
001-TC/Z	9	6000	Nominal	42	54	27	19	16
002-TC/Z	11	6000	Nominal	54	68	38	24	20
003-TC/Z	14	6000	Nominal	70	78	43	27	24
004-TC/Z	18	5500	Nominal	93	74	30	26	22
005-TC/Y	20	6500	0.07	97	74	35	25	24
006-TC/X	22	5500	0.14	105	84	38	32	20
007-TC/W	24	5500	0.21	105	111	43	40	31
008-TC/V	28	5500	0.28	120	95	51	37	21
009-TC/U	32	5500	0.42	135	108	58	39	30
009-TC/US	38	5500	0.55	144	120	66	48	24
010-TC/T	44	4400	0.63	160	132	71	49	34
011-TC/S	45	4300	0.77	164	133	75	51	31
012-TC/R	44	4200	0.98	176	147	71	53	41
013-TC/Q	50	3750	1.54	188	145	80	53	39
014-TC/P	55	3200	2.1	212	155	95	56	43
015-TC/O	70	2750	3.1	240	173	118	62	49
016-TC/N	85	2700	4.2	270	181	140	80	45
017-TC/M	90	2600	6.6	280	215	145	76	63
018-TC/L	95	2550	8.4	310	195	154	90	15
019-TC/K	100	2450	11.0	316	202	159	95	10
020-TC/J	125	2200	16.8	370	225	203	110	6
021-TC/I	125	2000	21.0	370	240	203	115	10
022-TC/H	140	1700	33.6	412	256	237	118	20
023-TC/G	140	1600	52.0	448	280	230	125	30
024-TC/F	170	1300	75.2	530	282	315	128	26
025-TC/E	145	1250	98.1	546	365	260	147	71
026-TC/D	145	1080	117.1	630	457	387	203	51
027-TC/C	on enq	960	138	746				On enquiry
028-TC/B	on enq	960	173	746				On enquiry

Contact For Quote:

HIC INTERNATIONAL CO -Motors Drive Tyre Coupling Div

D-136, Shankar Road, New Delhi - 110060, India

Phone: 91-11-6547 2400, 2874 5120

Fax: 91-11-2874 2791

E-mail : universal@hic-india.com; belts@universaldelhi.org

Website : <http://www.rubber-steel-industrial-products.com>

Key personnel : Mr. Anil Gupta, President



Motor-Generator Drive Flexible Tyre Couplings Technical Specifications



Coupling Sectional View (TC-SERIES)

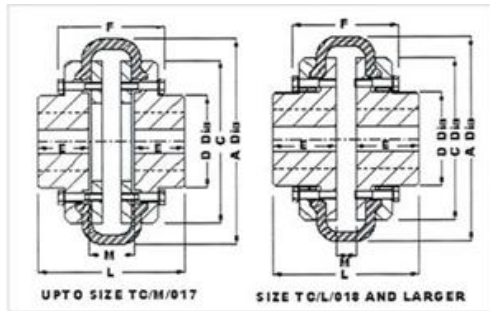

TC Rubber Tyre Couplings

Flexible Coupling Dimension Details F - series

Coupling flexible tyre size	Tyre coupling bore		A mm	L mm	D mm	E mm	C mm	G** mm	M** mm	F mm	Motor power per 100 rev./min kw.	Power per 100 rev./min H.P.	Max speed rev/min
	min mm	max. mm											
40-F	13	30	104	66	-	22	82	43	22	-	0.20	0.26	4400
45-F	13	32	120	74	-	25	94	43	24	-	0.35	0.46	4400
50-F	18	38	133	89	79	32	100	43	25	-	0.50	0.67	4400
60-F	18	48	165	109	73	38	125	43	33	-	1.05	1.40	3900
70-F	20	55	197	130	82	45	144	10	40	101	1.60	2.14	3600
80-F	26	65	211	145	95	51	167	10	43	106	2.55	3.41	3000
85-F	32	70	222	150	103	53	179	13	44	107	3.10	4.15	2900
90-F	32	76	235	160	110	57	188	13	46	119	3.75	5.02	2800
100-F	32	85	254	168	124	60	216	13	48	123	5.19	6.95	2500
110-F	32	90	279	174	134	65	233	14	44	127	7.32	9.80	2200
120-F	39	102	314	201	152	76	264	14	49	140	12.20	16.34	2000
140-F	76	120	359	211	195	89	311	14	24	152	19.20	25.72	1700
160-F	75	140	402	234	216	102	345	19	30	156	32.10	43.01	1500
180-F	75	175	470	274	266	114	398	19	46	188	57.00	76.38	1400



Contact For Quote:

HIC INTERNATIONAL CO -Motors Drive Tyre Coupling Div

D-136, Shankar Road, New Delhi - 110060, India

Phone: 91-11-6547 2400, 2874 5120

Fax: 91-11-2874 2791

E-mail : universal@hic-india.com; belts@universaldelhi.org

Website : <http://www.rubber-steel-industrial-products.com>

Key personnel : Mr. Anil Gupta, President



Motor-Generator Drive Flexible Tyre Couplings Technical Specifications



G* is the amount by which clamping screws need to be withdrawn to release tyre.

M** is the distance between flanges.

Normally shaft ends may be kept M distance apart, however, they can be kept at larger distance apart. Care being taken that sufficient shaft keyway length is covered by the Hub. The shaft length can also be brought nearer each other keeping in mind the end-play between the shafts to avoid chattering.

Coupling Sectional View (F-SERIES)

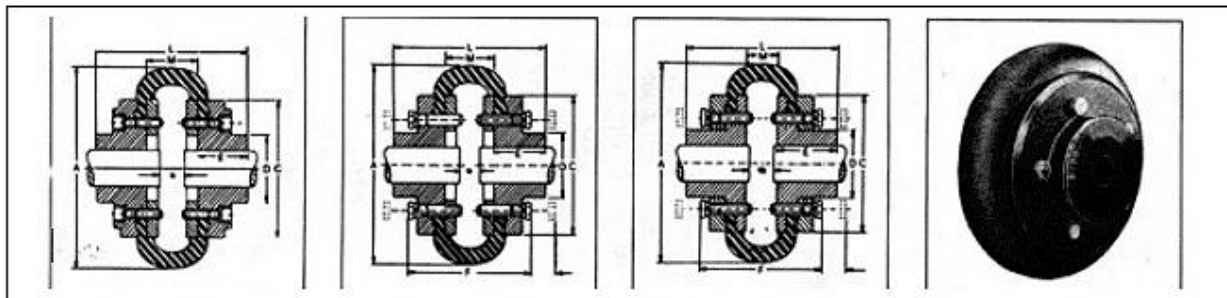

From Size 40 F to 60 F

From Size 70 F to 120 F

From Size 140 F & onwards

F Tyre Couplings



Contact For Quote:

HIC INTERNATIONAL CO -Motors Drive Tyre Coupling Div

D-136, Shankar Road, New Delhi - 110060, India

Phone: 91-11-6547 2400, 2874 5120

Fax: 91-11-2874 2791

E-mail : universal@hic-india.com; belts@universaldelhi.org

Website : <http://www.rubber-steel-industrial-products.com>

Key personnel : Mr. Anil Gupta, President



Motor-Generator Drive Flexible Tyre Couplings Technical Specifications



Flexible Shaft Coupling Dimension Details

Flex shaft coupling size	Coupling max. bore mm (6)	Max speed RPM	Rating		Couplings approx. dimension (mm)				
			Torque motor Kg. M.	H.P./100 RPM	Tyre O.D. (1)	Coupling length (2)	Hub dia (3)	Flange length (4)	Gap bet. two flanges (5)
34-PH	10	7000	Nominal	Nominal	34	34	14	16	6
40-PH	12	7000	-do-	-do-	40	40	17	19	8
46-PH	15	6500	0.87	0.12	46	40	22	19	8
56-PH	18	6000	1.08	0.15	56	48	26	22	11
66-PH	25	6000	1.52	2.21	66	54	36	25	11
76-PH	27	6000	1.81	0.25	76	66	39	30	14
86-PH	34	6000	2.90	0.40	86	76	49	35	14
96-PH	36	5500	3.62	0.50	96	76	51	35	16
106-PH	38	5500	4.35	0.60	106	76	54	35	18
116-PH	42	5500	5.43	0.75	116	88	60	40	22
126-PH	48	5500	9.00	1.25	126	88	68	40	22
140-PH	50	5500	12.70	1.75	140	100	72	46	26
160-PH	57	5000	16.40	2.25	160	108	82	50	28
178-PH	60	4500	22.0	3.00	178	128	100	60	32
190-PH	65	4000	29.0	4.00	190	146	105	70	30
218-PH	75	3500	43.5	6.00	218	160	124	75	36
250-PH	80	3000	62.0	8.50	250	192	145	90	40
272-PH	100	2750	80.0	11.00	272	205	163	90	55
292-PH	105	2600	109	15.00	292	228	168	105	47
316L-PH	90	2500	174	24.00	316	195	150	90	47
316H-PH	115	2500	174	24.00	316	245	190	115	47
342L-PH	90	2250	232	32.00	342	195	150	90	53
342H-PH	120	2250	232	32.00	342	255	198	120	53
390L-PH	100	2000	290	40.00	390	218	165	100	57
390H-PH	140	2000	290	40.00	390	298	230	140	57
450L-PH	130	1600	508	70.00	450	270	216	125	60
50H-PH	175	1600	508	70.00	450	360	286	170	60
520L-PH	150	1400	726	100	520	294	250	135	62
520H-PH	220	1400	7176	100	520	384	354	180	62
600-PH		1300	1310	180	600				
672-PH		1100	1960	270	672				
725-PH		950	2900	400	725				
812-PH		850	4356	600	812				
1000-PH		750	6534	900	1000				
1100-PH		650	8712	1200	1100				
1175-PH		550	10890	1500	1175				
1250-PH		500	14520	2000	1250				



Contact For Quote:

HIC INTERNATIONAL CO -Motors Drive Tyre Coupling Div

D-136, Shankar Road, New Delhi - 110060, India

Phone: 91-11-6547 2400, 2874 5120

Fax: 91-11-2874 2791

E-mail : universal@hic-india.com; belts@universaldelhi.org

Website : <http://www.rubber-steel-industrial-products.com>

Key personnel : Mr. Anil Gupta, President



Motor-Generator Drive Flexible Tyre Couplings Technical Specifications



Coupling Sectional View (PH-SERIES)

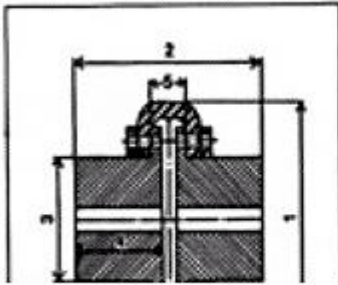

Up to Size 520 PH

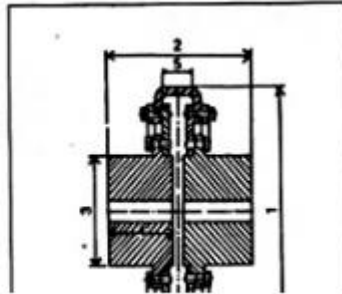

For Sizes 600 PH to 1250 PH

PH Tyre Coupling

Coupling Tire Information To Be Supplied With Enquiry or Order

1. Motor HP rating i.e. 15 or 60 Horse Power & so on.
2. RPM at which coupling is to run i.e. 650 or 1400 & so on.
3. Bore size in mm i.e. 9 or 15 mm & so on.
4. Coupling Type i.e. TC series or F series or PH series.
5. Machine type.
6. Quantity in nos.

Disclaimer: Information's, written and verbal are provided by HIC, relative to its products which it determines to be reliable & no liabilities of whatsoever nature in regards to its uses. The purchaser of UNIVERSAL brand industrial products should determine for itself the suitability of such products.



Contact For Quote:

HIC INTERNATIONAL CO -Motors Drive Tyre Coupling Div

D-136, Shankar Road, New Delhi - 110060, India

Phone: 91-11-6547 2400, 2874 5120

Fax: 91-11-2874 2791

E-mail : universal@hic-india.com; belts@universaldelhi.org

Website : <http://www.rubber-steel-industrial-products.com>

Key personnel : Mr. Anil Gupta, President